

T.O. CONCRETE  
EL 34' - 8"

APEX OF ARCH ( PRE CAST )

6" X 6" X 1/2"  
WELD PLATE

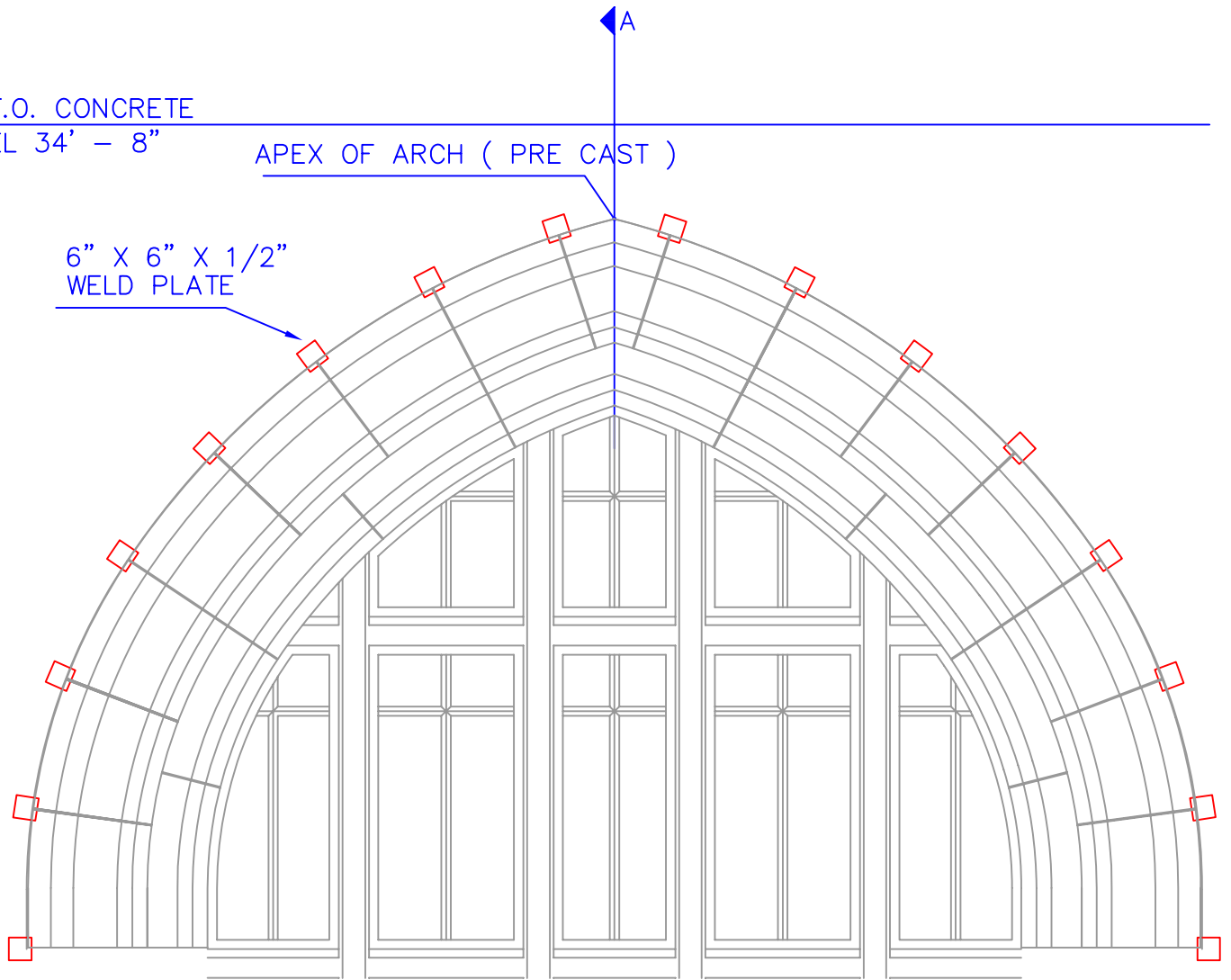

SOUTH ENTRY FACE PLATE LAYOUT

ERECTION DRAWING

PROJECT: \_\_\_\_\_ ITEM TAG: **SOUTH ENTRY CONCRETE 1**

REVISIONS: \_\_\_\_\_ SCALE: 1/4" = 1' DRAWN BY: \_\_\_\_\_

 Stromberg Architectural Products  DWG: \_\_\_\_\_ SHEET \_\_\_\_\_  
P.O. Box 8036, I-30 West, Greenville, TX 75404 (903) 454-8682 FAX (903) 454-3642 DATE: \_\_\_\_\_