

RIGHT SIDE VIEW

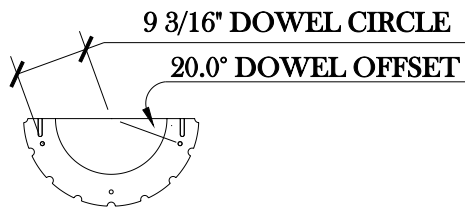

TOP VIEW

FASTENER DETAIL

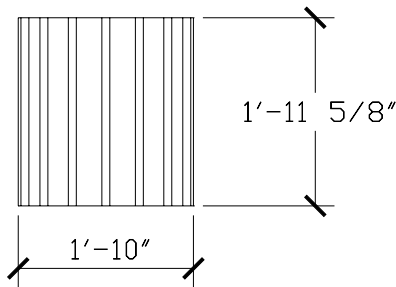
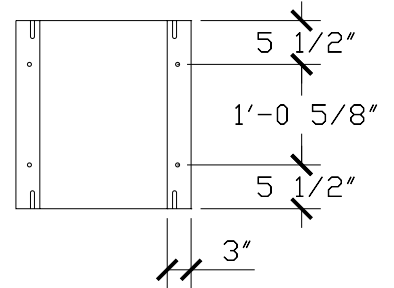

FRONT VIEW

FIELD CUT AS REQUIRED

ITEM TAG: LC-2
TOTAL # OF ITEM:
TOTAL LINEAR FEET: N/A
TOTAL CUBIC FEET:

DWG: LC-2	DRAWN BY:
DATE:	SHEET
CHECKED BY:	1
APPROVED BY:	OF 1

# Stromberg's Architectural Products



Cast Stone Columns, Fountains, and Specialties  
 P.O. Box 8036, I-30 West, Greenville, TX 75404  
 (903) 454-8682 FAX (903) 454-3642



PROJECT:	DRAWING TITLE:	REVISION	DATE
LOCATION:	COLUMN, 22"		
ARCHITECT:	CENTER SECTION		
G.C.:	SCALE: 1/2" = 1'		